

Flagship Class

Sanya 57

Fountaine Pajot, in association with the Berret Racoupeau design office, has produced a hallmark of definitive elegance and innovation.

The Sanya 57 is defined by its unique, contemporary design and has been strategically constructed for ocean cruising and unforgettably luxurious family holidays.

Affording all the pleasures of the sea, the Sanya 57 will take your breath away with the distinctive comfort, fixtures and services you've come to expect from Fountaine Pajot's prestigious Flagship Class.

This superb catamaran is the remarkable culmination of Fountaine Pajot's technological advances and innovative concepts, specifically designed for optimal safety and offshore performance.

The Lounge Deck is segregated from the helmstation and control lines, ensuring uninterrupted relaxation for guests while still allowing easy communication with the skipper.

Aesthetics are paramount and the boat's sleek lines are not compromised by practicality, with the solar panels integrated into the coachroof.

The ergonomic steering and maneuvering position affords panoramic visibility with a bimini to protect from inclement weather conditions, and is designed to be unobtrusive of the boat's living areas. The mainsail control lines are accessible from the coachroof.



The sheltered 25m² cockpit with sugar scoops is a welcoming and ambient area for relaxation. Its exclusive outdoor galley, equipped with sink, refrigerator, generous storage and adjustable table, helps create the perfect summer saloon. With custom-designed protection, it can double the closed sheltered area, all on the same level.

A remarkable 106m² of living area, all on one level, provides optimal space for enjoying cruises with treasured friends or unwinding in comfort on intimate getaways.

The dining and living room exude a refined yet relaxing ambience, courtesy of the discerning choice of textiles and furnishings, lighting, central island in galley, and the flexibility to customise the area's layout according to your specific needs. At anchor or at sea, the outstanding panorama is a unique signature of the Sanya 57.

For an 'à la carte' programme, or for family cruises, the six-cabin version offers beautiful guest cabins each featuring sea views and private bathroom. A guest bathroom, accessible via the main saloon, is a thoughtful design feature greatly appreciated when at sea. All cabins and passageways feature the latest in furnishings and fixtures with an impressive contemporary design.

Sanya 57 images are an artist's impression.



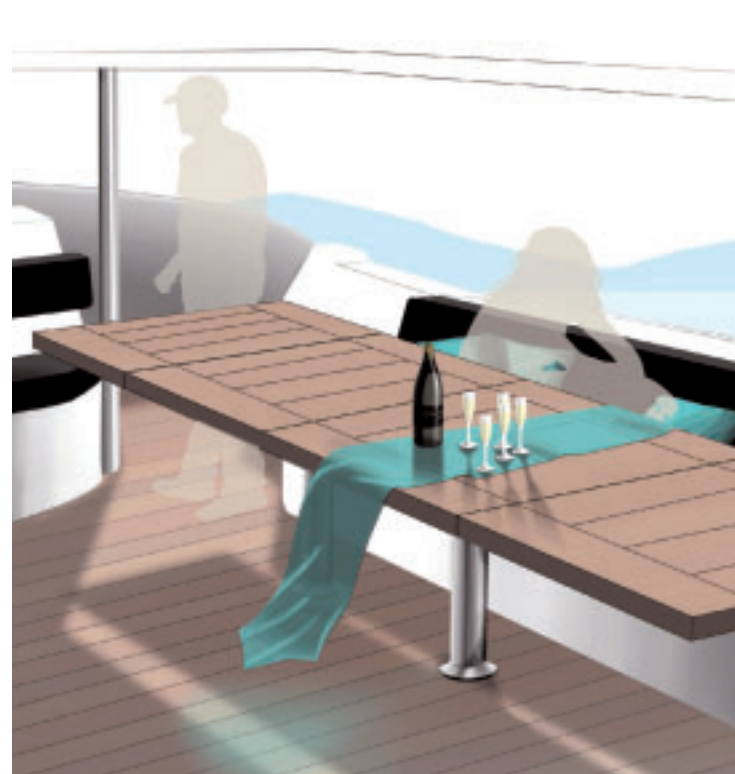

Flagship Class

Sanya 57

Specifications

LOA	17.26 m / 57.00 ft
Beam	8.88 m / 29.30 ft
Draft	1.40 m / 4.60 ft
Air Draft	23.10 m / 75.70 ft
Displacement	18.8 tonnes
Sail Area Genoa	65 m ² / 700 sq ft
Sail Area Mainsail	110 m ² / 1184 sq ft
Engines - larger optional	2 x 75 hp
Freshwater Capacity	1050 litre - larger optional
Diesel Capacity	1 x 1100 litre - larger optional
Architects and Designer	Berret - Racoupeau
Layout Options	Standard – 5 doubles + 1 crew cabin / 6 bathrooms Owner's – 4 doubles + 1 crew cabin / 5 bathroom

Sanya 57 images are an artist's impression.

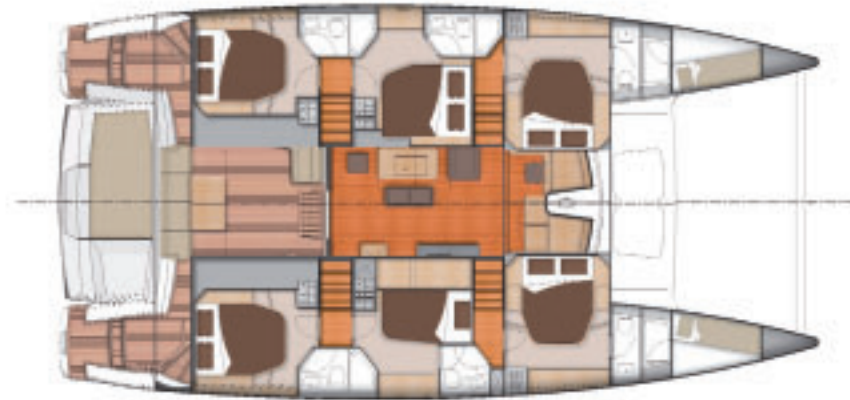

Standard Version

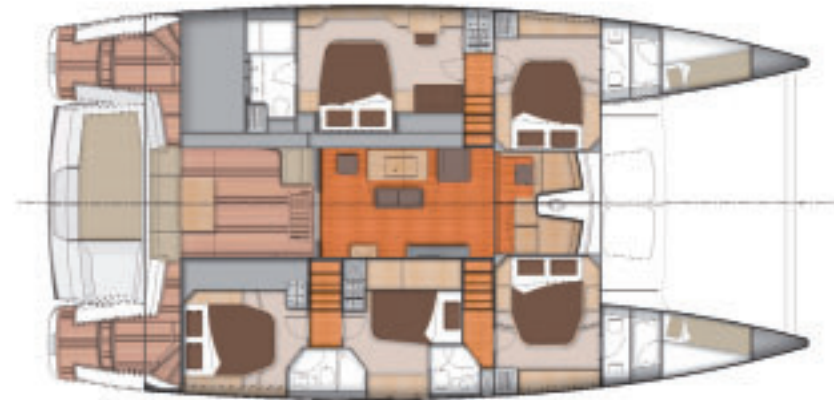

Owner's Version